

**NOTICE!!**

**These documents have been scanned!**

**Do not place un-scanned documents beneath this notice!**

**Do not remove this notice from this file!**

GPO Jacket No. 560-102  
Print Order 61540  
Rise Business Services, LLC  
Job=AZ15 4/29/2019



Box Number= AZ15007



Claim Begin-End: AMC444244-AMC444245

1 Initial Receipt



AZ15007-4

AMC450400-AMC453366



**United States Department of the Interior**  
**Bureau of Land Management**  
 DIV OF LANDS, MINRLS & ENERGY  
 ONE N CENTRAL AVE  
 PHOENIX, AZ 85004 -4427  
 Phone: 602-417-9200

Receipt

No: 3843159

<b>Transaction #:</b> 3951667	
<b>Date of Transaction:</b> 05/23/2017	
CUSTOMER:	
JUSTIN A YEO 38024 N 23RD AVE PHOENIX,AZ 85086-9623 US	

LINE #	QTY	DESCRIPTION	REMARKS	UNIT PRICE	TOTAL
1	2.00	LOCATABLE MINERALS / MINING CLAIMS-NEW,UNADJUD, ONE OR MORE AUTH NOS / NEW MINING CLAIM PROCESSING FEE <b>CASES:</b> AMC444244/\$20.00, AMC444245/\$20.00		- n/a -	40.00
2	2.00	LOCATABLE MINERALS / MINING CLAIMS-NEW,UNADJUD, ONE OR MORE AUTH NOS / NEW MINING CLAIMS LOCATION FEE <b>CASES:</b> AMC444244/\$37.00, AMC444245/\$37.00		- n/a -	74.00
3	2.00	LOCATABLE MINERALS / MINING CLAIMS-NEW,UNADJUD, ONE OR MORE AUTH NOS / NEW MINING CLAIMS MAINTENANCE FEE <b>CASES:</b> AMC444244/\$155.00, AMC444245/\$155.00		- n/a -	310.00
<b>TOTAL:</b>					<b>\$424.00</b>

PAYMENT INFORMATION			
NOTE: Items will appear on credit card statement as "Bureau of Land Mgmt CO".			
1	AMOUNT:	400.00	POSTMARKED: N/A
	TYPE:	CASH	RECEIVED: 05/23/2017
	NAME:	YEO, JUSTIN A 38024 N 23RD AVE PHOENIX AZ 85086-9623 US	
2	AMOUNT:	24.00	POSTMARKED: N/A
	TYPE:	CREDIT CARD	RECEIVED: 05/23/2017
	NAME:	YEO, JUSTIN A 38024 N 23RD AVE PHOENIX AZ 85086-9623 US	
	CARD NO:	XXXXXXXXXXXX0833	AUTH CODE: 100846

NAME ON CARD:	JUSTIN YEO
EXPIRES:	10/2019
SIGNATURE:	

REMARKS

This receipt was generated by the automated BLM Collections and Billing System and is a paper representation of a portion of the official electronic record contained therein.

**NOTICE!!**

**These documents have been scanned!**

**Do not place un-scanned documents beneath this notice!**

**Do not remove this notice from this file!**

GPO Jacket No. 560-102  
Print Order 61540  
Rise Business Services, LLC  
Job=AZ15 4/29/2019



Box Number= AZ15007



Claim Begin-End: AMC444244-AMC444245

2 Correspondence



AZ15007-4 AMC450400-AMC453366



# United States Department of the Interior

BUREAU OF LAND MANAGEMENT

Arizona State Office

One North Central Avenue, Suite 800

Phoenix, Arizona 85004-4427

[www.blm.gov/az/](http://www.blm.gov/az/)  
MAY 04 2018



In Reply Refer To:

3800 (9200) RM

AMC443770, AMC444244

CERTIFIED MAIL - RETURN RECEIPT REQUESTED No. 9214 8901 9403 8305 8689 63

## DECISION

DAVID D WARNER : The block below contains a list of the claims  
3810 E GLENROSA AVE : affected.  
PHOENIX, AZ 85018-4807 :

---

AMC443770, AMC444245

LEGACY #1, LEGACY #2

---

## MINING CLAIMS DECLARED FORFEITED

The mining claims listed above have been declared forfeited as of December 30, 2017, for failure to timely file the required notice of intent (NOI) to hold for the 2017 assessment year.

A small miner's maintenance fee waiver certification was filed for this claim for the 2017 assessment year, which began on September 1, 2016 and ends September 1, 2017. Therefore, pursuant to regulations found at 43 CFR 3835.15, 3835.16 and 3835.31, a notice of intent to hold must have been filed for the 2017 assessment year on or before December 30, 2017, along with a \$10 processing fee per claim. Because your claim was located in the calendar year when the NOI was due, the NOI was curable.

A Notice requiring that the NOI be filed was mailed to the above address by certified mail. The NOI was required to be filed within 30 days of the date the Notice was either received or returned to this office unclaimed or undeliverable. The 30-day timeframe allowed has expired and no NOI has been received.

## Reclamation Requirements

You are required to reclaim all areas disturbed by your activities on lands encompassed by your mining claim(s) and/or site(s). After you complete the reclamation, you must notify the authorized officer of the appropriate surface managing agency so that the authorized officer may conduct a final site inspection and determine whether you may be released from liability. If you fail to reclaim the land to the satisfaction of the authorized officer, the surface management agency may cite you for noncompliance under its surface management regulations.

For land administered by the Bureau of Land Management (BLM), if you fail to reclaim the land to the satisfaction of the authorized officer as required in 43 CFR Subpart 3809, BLM will issue an order of noncompliance under 43 CFR 3809.601(a). If you fail to comply with the noncompliance order, BLM may take further action under 43 CFR 3809.604. Failure to conduct reclamation is a prohibited act that may subject you to criminal penalties. See 43 CFR 3809.605(h) and 43 CFR 3809.700.

### Appeal Procedures

This decision may be appealed to the Interior Board of Land Appeals, Office of the Secretary, in accordance with the regulations contained in 43 CFR, Part 4, and the enclosed Form 1842-1. If an appeal is taken, your notice of appeal must be filed in this office (at the above address) within 30 days from receipt of this decision. The appellant has the burden of showing that the decision appealed from is in error.

If you wish to file a petition pursuant to regulation 43 CFR 4.21 (58 FR 4939, January 19, 1993) for a stay of the effectiveness of this decision during the time that your appeal is being reviewed by the Board, the petition for a stay must accompany your notice of appeal. A petition for a stay is required to show sufficient justification based on the standards listed below. Copies of the notice of appeal and petition for a stay **must** also be submitted to each party named in this decision and to the Interior Board of Land Appeals and to the appropriate Office of the Solicitor (see 43 CFR 4.413) at the same time the original documents are filed with this office. If you request a stay, you have the burden of proof to demonstrate that a stay should be granted.

### Standards for Obtaining a Stay

Except as otherwise provided by law or other pertinent regulation, a petition for a stay of a decision pending appeal shall show sufficient justification based on the following standards:

- (1) The relative harm to the parties if the stay is granted or denied,
- (2) The likelihood of the appellant's success on the merits,
- (3) The likelihood of immediate and irreparable harm if the stay is not granted, and
- (4) Whether the public interest favors granting the stay.

Please include your AMC serial number(s) on all correspondence. If additional information is required, please contact RéAnn Myers at 602-417-9413.

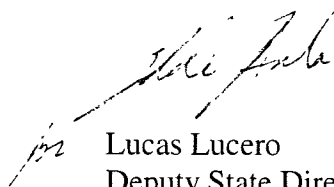

Lucas Lucero  
Deputy State Director  
Lands, Minerals and Energy Division

Enclosure



Date Produced: 05/14/2018

ConnectSuite Inc.:

The following is the delivery information for Certified Mail™/RRE item number 9214 8901 9403 8305 8689 63. Our records indicate that this item was delivered on 05/07/2018 at 01:08 p.m. in PHOENIX, AZ 85018. The scanned image of the recipient information is provided below.

Signature of Recipient :

A handwritten signature in black ink, appearing to read "George Davis".

Address of Recipient :

A handwritten address in black ink, appearing to read "2601 W 10th St Phoenix".

Thank you for selecting the Postal Service for your mailing needs. If you require additional assistance, please contact your local post office or Postal Service representative.

Sincerely,  
United States Postal Service

The customer reference number shown below is not validated or endorsed by the United States Postal Service. It is solely for customer use.

Customer Reference Number: C798987.4756000



pm 2/14/2018  
PB 2/15/18  
ll 2/15/18

FEB 15 2018

In Reply Refer To:  
3800 (9200) RM  
AMC444244

CERTIFIED MAIL - RETURN RECEIPT REQUESTED No. 9214 8901 9403 8304 3283 45

NOTICE

DAVID D WARNER	:	This Notice Affects the Claims
3810 E GLENROSA AVE	:	Shown in the Block Below.
PHOENIX, AZ 85018-4807	:	

---

AMC444245  
LEGACY #2

---

Mining Claim Location Notice(s) – Amendment(s) Required

Pursuant to Title 43 Code of Federal Regulations (CFR) 3832.1, the Bureau of Land Management (BLM), Arizona State Office, received your notices of location for recording mining claims. In accordance with 43 CFR 3832.12, the claims listed above cannot be accepted as filed and must be amended as noted below.

The claim is not in aliquot parts. You must describe placer claims by aliquot part and complete lots using the U.S. Public Land Survey System and its rectangular subdivisions (i.e., a 20 acre claim would be 1,320 x 660). In all cases, the description must be as compact and regular in form as possible. Your claim is 1320 x 640 feet. To be in aliquot parts, the length would remain 1,320 feet but the width would need to be reduced to 330 feet.

In accordance with 43 CFR 3832.12(c) (1) You must describe placer claims by aliquot part and complete lots using the U.S. Public Land Survey System and its rectangular subdivisions except when placer claims are (i) on unsurveyed Federal lands; (ii) Gulch or bench placer claims; or (iii) Bounded by other mining claims or non-mineral lands. If one of these situations exists you must describe the lands by protracted survey or by metes and bounds. In all cases, your description of the land must be as compact and regular in form as reasonably possible and should conform to the U.S. Public Land Survey System and its rectangular subdivisions as much as possible.

The amendment must provide one of the following:

1. Identify which situation exists that requires this placer mining claim to be located by metes and bounds and provide a metes and bounds description. If you believe the claim is a gulch placer, please provide a) a topographical map and b) the % steepness of the

Copy Rec'd



slope. A gulch placer is located on the bed of a river contained within steep, non-mineral canyon walls and the slope should be at least 35% to 60%.

2. Amend the mining claim using the U.S. Public Land Survey System and its rectangular subdivisions and describe the mining claim by aliquot parts and complete lots.

Keep in mind that when amending a mining claim, no new ground can be taken in. A placer mining claim must contain at least 10 acres. Therefore an amended claim would have to contain at least 10 acres and must be described by aliquot parts. If this cannot be achieved, the claim should be relinquished and a new claim located correctly, rather than amending an incorrectly located claim.

If you are able to correctly amend the claims listed above and decide to do so, there is a \$10 BLM processing fee for each amendment. The amendments must be received by BLM within 30 days of your receipt of this notice. If the amendments are not received within the 30 day timeframe the mining claims will be declared null and void.

If additional information is required, please contact RéAnn Myers at 602-417-9413. Please include your AMC serial number(s) on all correspondence.

**/s/ Lucas Lucero**

Lucas Lucero  
Deputy State Director  
Lands, Minerals and Energy Division

Enclosure(s)

**CERTIFIED MAIL**

AZ 852

POSTED 10  
PM 111

repost

5/2018  
**POSTAGE**

**\$05.58<sup>00</sup>**

US OFFICIAL MAIL  
\$300 Penalty  
For Private Use

ZIP 85004

041E11101433



PHOENIX, ARIZONA

2018 MAR -9 P 2:14

RECEIVED  
POST OFFICE

8-2-18

NIXIE

850 DE 1

0003/07/18

RETURN TO SENDER  
UNCLAIMED  
UNABLE TO FORWARD

BC: 85004442700

\*2514-10798-15-38

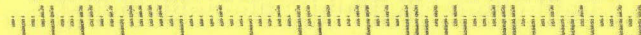

IA KI:9333520029

UNC

85004442700

US Department of the Interior  
Bureau of Land Management  
1 N Central Ave Ste 800  
Phoenix, AZ 85004

---

USPS CERTIFIED MAIL



9214 8901 9403 8304 3283 45

---

DAVID D WARNER  
3810 E GLENROSA AVE  
PHOENIX AZ 85018-4807

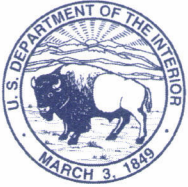

# United States Department of the Interior



## BUREAU OF LAND MANAGEMENT

Arizona State Office

One North Central Avenue, Suite 800

Phoenix, Arizona 85004-4427

[www.blm.gov/az/](http://www.blm.gov/az/)

In Reply Refer To:  
3800 (9200) RM  
AMC444244

CERTIFIED MAIL - RETURN RECEIPT REQUESTED No. 9214 8901 9403 8304 3283 45

### NOTICE

DAVID D WARNER	:	This Notice Affects the Claims
3810 E GLENROSA AVE	:	Shown in the Block Below.
PHOENIX, AZ 85018-4807	:	

---

AMC444245  
LEGACY #2

---

### Mining Claim Location Notice(s) – Amendment(s) Required

Pursuant to Title 43 Code of Federal Regulations (CFR) 3832.1, the Bureau of Land Management (BLM), Arizona State Office, received your notices of location for recording mining claims. In accordance with 43 CFR 3832.12, the claims listed above cannot be accepted as filed and must be amended as noted below.

The claim is not in aliquot parts. You must describe placer claims by aliquot part and complete lots using the U.S. Public Land Survey System and its rectangular subdivisions (i.e., a 20 acre claim would be 1,320 x 660). In all cases, the description must be as compact and regular in form as possible. Your claim is 1320 x 640 feet. To be in aliquot parts, the length would remain 1,320 feet but the width would need to be reduced to 330 feet.

In accordance with 43 CFR 3832.12(c) (1) You must describe placer claims by aliquot part and complete lots using the U.S. Public Land Survey System and its rectangular subdivisions except when placer claims are (i) on unsurveyed Federal lands; (ii) Gulch or bench placer claims; or (iii) Bounded by other mining claims or non-mineral lands. If one of these situations exists you must describe the lands by protracted survey or by metes and bounds. In all cases, your description of the land must be as compact and regular in form as reasonably possible and should conform to the U.S. Public Land Survey System and its rectangular subdivisions as much as possible.

The amendment must provide one of the following:

1. Identify which situation exists that requires this placer mining claim to be located by metes and bounds and provide a metes and bounds description. If you believe the claim is a gulch placer, please provide a) a topographical map and b) the % steepness of the

slope. A gulch placer is located on the bed of a river contained within steep, non-mineral canyon walls and the slope should be at least 35% to 60%.

2. Amend the mining claim using the U.S. Public Land Survey System and its rectangular subdivisions and describe the mining claim by aliquot parts and complete lots.

Keep in mind that when amending a mining claim, no new ground can be taken in. A placer mining claim must contain at least 10 acres. Therefore an amended claim would have to contain at least 10 acres and must be described by aliquot parts. If this cannot be achieved, the claim should be relinquished and a new claim located correctly, rather than amending an incorrectly located claim.

If you are able to correctly amend the claims listed above and decide to do so, there is a \$10 BLM processing fee for each amendment. The amendments must be received by BLM within 30 days of your receipt of this notice. If the amendments are not received within the 30 day timeframe the mining claims will be declared null and void.

If additional information is required, please contact RéAnn Myers at 602-417-9413. Please include your AMC serial number(s) on all correspondence.

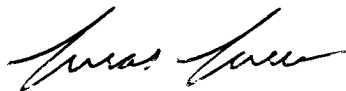

Lucas Lucero  
Deputy State Director  
Lands, Minerals and Energy Division

Enclosure(s)

## INFORMATION REGARDING LOCATING

### PLACER MINING CLAIMS

1. A location notice must always be signed by each mining claimant.
2. Placer claims **CANNOT** be filed with Lode Claim dimensions (1500 x 600)
3. The map of the claim **MUST** clearly identify and show the quarter section lines and where the claim lies within the quarter section. The claim dimensions must be noted on the map.
4. **Placer claims**, in accordance with 43 CFR 3832.12(c) (1) **MUST be described by aliquot part and complete lots using the U.S. Public Land Survey System and its rectangular subdivisions** except when placer claims are (i) on unsurveyed Federal lands; (ii) Gulch or bench placer claims; or (iii) Bounded by other mining claims or nonmineral lands. If one of these situations exists, the claim must be described by metes and bounds.
5. **A placer claim should not be located diagonally or in an odd or unusual shape.**
6. Using the rectangular survey system the following are examples of correct dimensions for a placer claim:  
20 acre claim = 1320 x 660;                      40 acre claim = 1320 x 1320;  
60 acres claim = 1980 x 1320;                80 acre claim = 2640 x 1320;  
160 acre claim = 2640 x 2640
7. **A Placer Claim must always conform to the following length requirements.** Even if you have a situation where you must locate the claim using metes and bounds you must still comply with these requirements to keep your claim in compact form. (43 CFR 3832.12(a)(1))

<u># of Persons Locating</u>	<u>Claim Must Fit Within Exterior Boundaries of:</u>	<u>Length Cannot Exceed</u>
1 or 2 persons	one square 40 acre parcel	1320 feet
3 or 4 persons	two square contiguous 40 acre parcels	2640 feet
5 or 6 persons	three square contiguous 40 acre parcels	3960 feet
7 or 8 persons	four square contiguous 40 acre parcels	5280 feet

(6/1/2015)

5280 feet = 1 mile

2640 feet

1320 feet

1320 feet

2640 feet

2640 feet

NW 1/4  
160 ACRES

W 1/2 NE 1/4  
80 ACRES

E 1/2 NE 1/4  
80 ACRES

SECTION  
CENTER

5280 feet = 1 mile

1320 feet

660 feet

NW 1/4 SW 1/4  
40 ACRES

NE 1/4 SW 1/4  
40 ACRES

W 1/2  
NW 1/4  
SE 1/4  
20 ACRES

E 1/2  
NW 1/4  
SE 1/4  
20 ACRES

N 1/2 NE 1/4 SE 1/4  
20 ACRES

S 1/2 NE 1/4 SE 1/4  
20 ACRES

1320 feet

660 feet

660 feet

SW 1/4 SW 1/4  
40 ACRES

SE 1/4 SW 1/4  
40 ACRES

NW 1/4  
SW 1/4  
SE 1/4  
10 ACRES

NE 1/4  
SW 1/4  
SE 1/4  
10 ACRES

NW 1/4  
SE 1/4  
SE 1/4  
10 ACRES

NE 1/4  
SE 1/4  
SE 1/4  
10 ACRES

SW 1/4  
SW 1/4  
SE 1/4  
10 ACRES

SE 1/4  
SW 1/4  
SE 1/4  
10 ACRES

SW 1/4  
SE 1/4  
SE 1/4  
10 ACRES

SE 1/4  
SE 1/4  
SE 1/4  
10 ACRES

1320 feet

1320 feet

660 feet

660 feet

660 feet

660 feet

660 feet

Aliquot parts of one rectangular survey section



# Aliquot measurement grid template

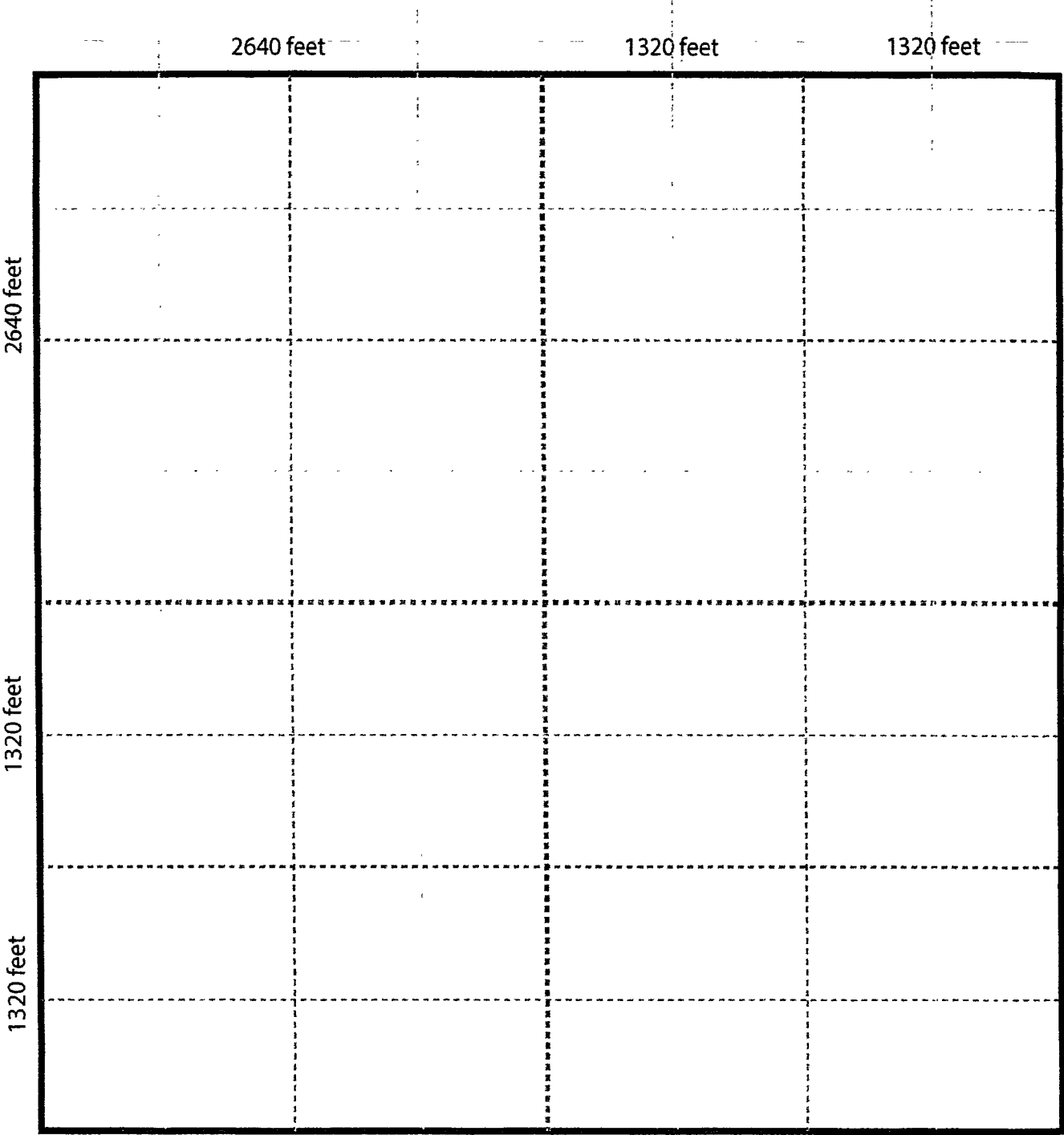



# United States Department of the Interior



BUREAU OF LAND MANAGEMENT

Arizona State Office

One North Central Avenue, Suite 800

Phoenix, Arizona 85004-4427

[www.blm.gov/az/](http://www.blm.gov/az/)

In Reply Refer To:

3800 (9200) RM

AMC443770, AMC444244

JAN 26 2018

CERTIFIED MAIL - RETURN RECEIPT REQUESTED No. 7017 0660 0000 3024 2109

## NOTICE

DAVID D WARNER : The block below contains a list of the claims  
3810 E GLENROSA AVE : affected.  
PHOENIX, AZ 85018-4807 :

---

AMC443770, AMC444245  
LEGACY #1, LEGACY #2

---

### MINING CLAIMS HELD FOR REJECTION

A small miner's maintenance fee waiver certification was received in this office for the 2018 assessment year for the mining claims listed above. We did not receive a Notice of Intent to Hold (NOI) on or before December 30, 2017.

Pursuant to the Federal Land Policy and Management Act of 1976, as amended, and regulations found at 43 CFR 3835.15, you are not required to perform assessment work in the calendar year in which you locate a mining claim or mill site. If in the calendar year the claim is located, a small miner maintenance fee waiver certification is filed for a mining claim, a notice of intent to hold must be filed on or before December 30<sup>th</sup> along with a \$10 processing fee per claim. However, because this requirement is regulatory, and not statutory, this is a curable defect.

Since your mining claims were located during the 2017 calendar year, you must file an NOI, along with the \$10 processing fee, within 30 days of your receipt of this notice. Failure to file the NOI and processing fee within 30 days of your receipt of this notice will constitute a forfeiture of the claim (43 CFR 3835.91).

Please include your AMC serial number(s) on all correspondence. If additional information is required, please contact RéAnn Myers at 602-417-9413.

Lucas Lucero  
Deputy State Director  
Lands, Minerals and Energy Division

22 3/1/18



FAQs > (<http://faq.usps.com/?articleId=220900>)

Track Another Package +

Tracking Number: 70170660000030242109

Remove X

Expected Delivery on

**TUESDAY**

**30** JANUARY 2018 ⓘ by **8:00pm** ⓘ

**Delivered**

January 30, 2018 at 2:13 pm  
Delivered, Left with Individual  
PHOENIX, AZ 85018

Get Updates ▾

---

Text & Email Updates



---

Tracking History



---

Product Information



---

See Less ^

**Can't find what you're looking for?**

Go to our FAQs section to find answers to your tracking questions.

**NOTICE!!**

**These documents have been scanned!**

**Do not place un-scanned documents beneath this notice!**

**Do not remove this notice from this file!**

GPO Jacket No. 560-102  
Print Order 61540  
Rise Business Services, LLC  
Job=AZ15 4/29/2019



Box Number= AZ15007



Claim Begin-End: AMC444244-AMC444245

3 Transfers



AZ15007-4 AMC450400-AMC453366

**NO  
DOCUMENTS  
FOUND**

NO DOCUMENTS FOUND  
NO DOCUMENTS FOUND

**NOTICE!!**

**These documents have been scanned!**

**Do not place un-scanned documents beneath this notice!**

**Do not remove this notice from this file!**

GPO Jacket No. 560-102  
Print Order 61540  
Rise Business Services, LLC  
Job=AZ15 4/29/2019



Box Number= AZ15007



Claim Begin-End: AMC444244-AMC444245

4 Annual Filings



AZ15007-4 AMC450400-AMC453366

UNIT STATES  
DEPARTMENT OF THE INTERIOR  
BUREAU OF LAND MANAGEMENT

FORM APPROVED  
OMB NO.: 1004-0114  
Expires: October 31, 2016

444244

**AFFIDAVIT OF ANNUAL ASSESSMENT WORK**

**WHEN RECORDED, MAIL DOCUMENT TO:**

NAME: Justin Allen Yeo

ADDRESS: 38027 N. 23rd Ave

CITY, STATE, ZIP: Phoenix, AZ 85086

**FOR COUNTY RECORDER'S USE**

No. of Claims 2  
x \$10/claim  
Total due BLM \$ 20

Rec. 4236674

**TO ALL WHOM IT MAY CONCERN:**

- The undersigned certifies that at least \$100 per claim was expended for development, labor and improvements, or equivalent value added, as the annual assessment work for the assessment year ending September 1, 2018 for the following contiguous unpatented mining claim(s), located in the County of Yavapai, in the State of Arizona.

BLM Serial No.	Name of Claim	Tp	Rg	Sec	Mer	County Recordation Book and Page No.	Date
444244	AZDG Paradise	12N	1W	21		2017-0028094	4/27/17
4449976	AZDG North	12N	1W	20		2017-0031722	4/27/17

RECEIVED  
 BLM AZ STATE OFFICE  
 2018 AUG 16 A 10:02  
 PHOENIX, ARIZONA

(Continued on page 2)

AD 9/26/18

2. Type of labor and improvements (specify what was done and give the total value for that labor and improvement to show at least \$100 for each claim). If a geological, geochemical, or geophysical survey was performed, as per 30 U.S.C. 28-1, reference the title of the report of survey, give cost and date of the survey and report, and indicate it was filed with the County Recorder:

Description of Work Performed	Value of Work Performed	Date Work Was Performed
Removed Boulders for walking Path & uncovered	\$ 2.50	1/27/2017
Gold bearing bench, cleared dead brush from Gold bearing ground to allow access		
Removed Boulders from gold bearing bench & cleared brush from access path to bench	\$ 150	2/3/2017

3. Name and mailing address of each person who performed the labor and improvements:

Name (please print)

Justin Allen Yeo  
Fred Dickinson

Current Mailing Address (please print)

38027 N. 23rd Ave, Phoenix, AZ 85086  
7815 W. Rock Springs Dr. Peoria, AZ 85383

4. Name and mailing address of each person who holds and claims the subject mining claim(s) for the valuable minerals contained therein. Be sure to indicate if there is a change of address:

Name (please print)

Justin Allen Yeo  
Malynda Dickinson

Current Mailing Address (please print)

38027 N. 23rd Ave Phoenix, AZ 85086  
7815 W. Rock Spring Dr. Peoria, AZ 85383

RECEIVED  
 DEPT. OF MINES & METALS  
 ARIZONA STATE OFFICE  
 PHOENIX, ARIZONA  
 2018 AUG 16 AM 10:02

5. The undersigned testifies that on the date of April 27th, 2017, all monuments required by law were erected upon the subject claim(s), and all notices required by law were posted on the subject claim(s) or copies thereof were in place, and at said date, each corner monument bore or contained



markings sufficient to appropriately designate the corner of the claim to which it pertains and the name of the claim(s).

I hereby certify under penalty of perjury under the laws of the State of ARIZONA that the foregoing statements are true and correct:

[Signature] Fred Dickinson Date: 8/16/18  
(Signature of person responsible for above statement)

Title 18 U.S.C. 1001 and 43 U.S.C. 1212 make it a crime for any person knowingly and willfully to make to any department or agency of the United States any false, fictitious or fraudulent statements or representations as to any matter within its jurisdiction.

**Notary Block**

SUBSCRIBED AND SWORN TO before me, this 16<sup>th</sup> day of August 2018

By: Fred W. Dickinson  
(Signature of Affiant)

Title: NOTARY [Signature]

My Commission Expires: 8/25/2019



**INSTRUCTIONS**

1. This is an optional form that may be used to satisfy the requirements for the Bureau of Land Management (BLM) under the provisions of 43 U.S.C §1744 and 30 U.S.C. §28-28d and the regulations thereunder (43 CFR part 3835) Since local and State laws may vary, you should contact your local and State agencies where the claims are located to ensure all applicable laws and requirements are satisfied.
2. The claimant(s) must fill in the date in paragraph 1 for the applicable assessment year and the county and state where the claims are located.
3. All claim names, BLM serial numbers, legal descriptions, and original county recording information must be listed for the claims pertaining to this assessment notice.
4. The claimant(s) must complete paragraph 2 listing all labor or improvements which was performed on or did benefit the subject mining claims. The value and date of the labor or improvements must also be listed. The total amount of labor or improvements can be listed, but the total expenditure must equal at least \$100 for each claim.
5. The names and current mailing addresses of the person(s) performing the labor shall be listed in paragraph 3.
6. The name and current mailing address of each owner (claimant) of the claims shall be listed in paragraph 4. The mailing address shall be the owner's address and not the address of an agent or anyone representing the claimant. Be sure to note if there has been a change of address.
7. Paragraph 5 shall be completed to show the date it was verified that all monuments required by law were properly erected, all notices were posted, and that corners were appropriately designated for all claims listed.
8. An exact legible reproduction or duplicate (other than microfilm or other electronic media) of this affidavit or another type of affidavit of assessment work that you file or will file in the county where each claim is located, must be filed with the BLM on or before December 30 of the calendar year in which the assessment year ends. For mill or tunnel sites, a separate notice of intent to hold must be filed with the BLM on or before December 30. Requirements for filing a notice of intent to hold can be found at 43 CFR 3835.33.
9. A processing fee of \$10 for each claim listed must be remitted to the BLM along with this or any other affidavit of assessment work.

PHOENIX, ARIZONA

RECEIVED  
BLM AZ STATE OFFICE

**United States Department of the Interior**  
**Bureau of Land Management**  
 DIV OF LANDS, MINRLS & ENERGY  
 ONE N CENTRAL AVE  
 PHOENIX, AZ 85004 -4427  
 Phone: 602-417-9200

Receipt

No: 4236674

<b>Transaction #:</b> 4352046	
<b>Date of Transaction:</b> 08/16/2018	
<b>CUSTOMER:</b>	
JUSTIN A YEO 38024 N 23RD AVE PHOENIX,AZ 85086-9623 US	

LINE #	QTY	DESCRIPTION	REMARKS	UNIT PRICE	TOTAL
1	1.00	LOCATABLE MINERALS / MINING CLAIMS- NOT NEW-UNADJUD,ONE AUTH NO. ONLY / MINING CLAIM MONEY RECEIVED <b>CASES: AMC444244/\$20.00</b>	2018 POL & 2019 WAIV (2)	- n/a -	20.00
<b>TOTAL:</b>					<b>\$20.00</b>

PAYMENT INFORMATION			
NOTE: Items will appear on credit card statement as "Bureau of Land Mgmt CO".			
1	AMOUNT:	20.00	POSTMARKED: N/A
	TYPE:	CREDIT CARD	RECEIVED: 08/16/2018
	NAME:	YEO, JUSTIN A 38024 N 23RD AVE PHOENIX AZ 85086-9623 US	
	CARD NO:	XXXXXXXXXXXX0594	AUTH CODE: 031013
	NAME ON CARD:	FRED W DICKINSON JR	
	SIGNATURE:		

REMARKS

This receipt was generated by the automated BLM Collections and Billing System and is a paper representation of a portion of the official electronic record contained therein.

UNITED STATES  
DEPARTMENT OF THE INTERIOR  
BUREAU OF LAND MANAGEMENT  
**MAINTENANCE FEE WAIVER CERTIFICATION**

385  
PER  
233

444244  
444996  
FORM APPROVED  
OMB NO. 1004-0114  
Expires: January 31, 2020

SEE INSTRUCTIONS ON PAGE 2

- This small miner waiver is filed for the assessment year beginning on September 1, 2018 and ending on September 1, 2019.
- The undersigned and all related parties owned ten or fewer mining claims, mill, or tunnel sites located and maintained on Federal lands in the United States of America on September 1, 2018.
- The undersigned have performed the assessment work required by law for each mining claim listed prior to filing this waiver and understand that by filing this form, the undersigned must file an affidavit of assessment work with the Bureau of Land Management (BLM) by the December 30th following the filing of this waiver.
- The undersigned understand that if the assessment work obligation has not yet come due under 30 U.S.C. 28 (for those claims in their first assessment year only), a notice of intent to hold reciting this condition must be recorded by the December 30th following the filing of this waiver.
- The undersigned understand that mill and tunnel sites may also be listed on this waiver and be waived from payment of the maintenance fee, and that a notice of intent to hold for these sites is required to be filed with the BLM by the December 30th following the filing of this waiver.
- The undersigned understand and acknowledge that pursuant to 43 U.S.C. 1212 and 18 U.S.C. 1001, the filing or recording of a false, fictitious, or fraudulent document with the BLM may result in a fine of up to \$250,000, a prison term not to exceed five years, or both.
- The mining claims, mill or tunnel sites for which this waiver from payment of the maintenance fees is requested are:

CLAIM OR SITE NAME	BLM RECORDATION SERIAL NUMBER
1. <u>AZDG Paradise</u>	<u>AMC 444244</u> (913)
2. <u>AZDG North</u> is <u>AMC 444996</u> PB	<u>AMC 444996</u> PB
3.	
4.	
5.	
6.	
7.	
8.	
9.	
10.	

RECEIVED  
BLM AZ STATE OFFICE  
2018 AUG 28 A 10:05  
PHOENIX, ARIZONA

The owner(s) (claimants) of the above mining claims and sites are:

4ct Justin Allen Yeo  
(Owner's Name - Please Print)  
38024 N. 23rd Ave ✓  
(Owner's Mailing Address)

[Signature]  
(Owner's Signature)  
Phoenix AZ 85086  
(City) (State) (Zip Code)

4ct Malynnda Dickinson  
(Owner's Name - Please Print)  
7815 W. Rock Springs Dr. ✓  
(Owner's Mailing Address)

[Signature]  
(Owner's Signature)  
Peoria AZ 85383  
(City) (State) (Zip Code)

(Owner's Name - Please Print)  
  
(Owner's Mailing Address)

(Owner's Signature)  
  
(City) (State) (Zip Code)

(Owner's Name - Please Print)  
  
(Owner's Mailing Address)

(Owner's Signature)  
  
(City) (State) (Zip Code)

(Continued on page 2)

ENTERED  
SEP 14 2018  
AC 247 REMOVED  
NVR CURED  
BY: BPS 9/26/18 PB

NW/PB

(Owner's Name - Please Print)	(Owner's Signature)		
(Owner's Mailing Address)	(City)	(State)	(Zip Code)
(Owner's Name - Please Print)	(Owner's Signature)		
(Owner's Mailing Address)	(City)	(State)	(Zip Code)
(Owner's Name - Please Print)	(Owner's Signature)		
(Owner's Mailing Address)	(City)	(State)	(Zip Code)
(Owner's Name - Please Print)	(Owner's Signature)		
(Owner's Mailing Address)	(City)	(State)	(Zip Code)

18 U.S.C. 1001 and 43 U.S.C. 1212 make it a crime for any person knowingly and willfully to make to any department or agency of the United States any false, fictitious or fraudulent statements or representations as to any matter within its jurisdiction.

**INSTRUCTIONS**

- 1 This certification is made under the provisions of 43 U.S.C. § 1744 and 30 U.S.C. § 28-28k and the regulations thereunder (43 CFR Part 3830)
- 2 The claimant(s) must fill in the dates in paragraph 1 for the beginning and ending of the assessment year for which this waiver is sought.
- 3 The claimant(s) must fill in the date in paragraph 2 for the beginning of the assessment year for which this waiver is sought
- 4 All claim and site names and BLM serial numbers must be listed for the mining claims, mill sites, and tunnel sites for which the waiver is sought.
- 5 All owners of the mining claims, mill sites, and tunnel sites and their addresses must be given
- 6 This waiver form must be signed by all the claimants or their designated agent, in original form. If an agent is designated, a notarized designation of agent, signed by all of the claimants with proper address given, must be submitted with this waiver.
- 7 This form must be filed no later than September 1st for the upcoming assessment year in the BLM State Office where the mining claims or sites are recorded, or the waiver cannot be granted by the BLM. (Example: To obtain a waiver for the assessment year 2012, which begins on September 1, 2011, you must qualify for and file for a waiver no later than September 1, 2011, in the proper BLM State Office.)
- 8 For all mining claims which require assessment work, you must record an affidavit of labor on or before the December 30th immediately following the filing of this waiver. For all other mining claims or sites waived, you must record a notice of intent to hold on or before the December 30th immediately following the filing of this waiver.
- 9 Mill and tunnel sites may also be listed on this waiver and be waived from payment of the maintenance fee. A notice of intent to hold for these sites is required to be filed by the December 30th following the filing of this waiver.

**FOR OFFICIAL USE ONLY**

## NOTICES

The **Privacy Act** and 43 CFR 2.223(d) require that you be furnished the following information in connection with the information requested by this form.

**AUTHORITY:** 30 U.S.C. 28f and 43 CFR part 3835 permit collection of the information requested by this form.

**PRINCIPAL PURPOSE:** The BLM will use the information you provide to verify that the owner(s) (claimants(s)) of a mining claim has/have complied with 30 U.S.C. 28f and 43 CFR part 3835 and is/are entitled to perform assessment work in lieu of paying the maintenance fee for the mining claims listed on this form.

**ROUTINE USES:** The BLM will only disclose this information in accordance with the provisions at 43 CFR 2.231(b) and (c).

**EFFECT OF NOT PROVIDING INFORMATION:** Disclosure of the requested information is required by 30 U.S.C. 28f and 43 CFR part 3835 for those claimants qualified to request the small miner waiver allowed. Failure to submit all the requested information or to complete this form will delay the BLM's processing of the form and may preclude the BLM's acceptance of the maintenance fee waiver request, which may result in forfeiture of the mining claim or site by the claimant.

The **Paperwork Reduction Act** requires us to inform you that:

The BLM collects this information to determine whether or not you are qualified for waiver of maintenance fees.

Submission of the requested information is necessary to obtain or retain a benefit.

You do not have to respond to this or any other Federal agency-sponsored information collection unless it displays a currently valid OMB control number.

**BURDEN HOURS STATEMENT:** Public reporting burden for this form is estimated to average 20 minutes per response, including the time for reviewing instructions, gathering and maintaining data, and completing and reviewing the form. You may submit comments regarding the burden estimate or any other aspect of this form to: U.S. Department of the Interior, Bureau of Land Management (1004-0114), Bureau Information Collection Clearance Officer (WO-630), Mail Stop 401 LS, 1849 C St., N.W., Washington, D.C. 20240.

RECEIVED  
BLM AZ STATE OFFICE  
2018 AUG 28 A 10:05  
PHOENIX, ARIZONA

**Date and Time Run:**

9/25/2018 5:48:15 PM

Page 1 of @{numberOfPages}

**DEPARTMENT OF THE INTERIOR  
BUREAU OF LAND MANAGEMENT**

**Mining Claims**

**CUSTOMER INFORMATION**

**Admin State: AZ**

**Geo State: AZ**

**YEO JUSTIN A**

**38024 N 23RD AVE**

**PHOENIX AZ 85086-9623**

**Int Rel: CLAIMANT**

**Customer ID: 2412477**

Serial Number	Lead Serial Number	Claim Name	County	D	Case Type	Last A Yr	Location Date	Meridian Township Range Section	Subdiv
AMC443146	AMC443146	AZ GOLD DIGGERS 1	YAVAPAI	A	PLACER	2018	01/14/2017	14 0080N 0040W 007	NW
<u>AMC444244</u>	AMC444244	<u>AZDG PARADISE</u>	YAVAPAI	A	PLACER	2018	02/27/2017	14 0120N 0010W 021	SW
<u>AMC444996</u>	AMC444996	<u>AZDG NORTH</u>	YAVAPAI	A	PLACER	2018	04/27/2017	14 0120N 0010W 020	NE
AMC444997	AMC444996	AZDG PARADISE #2	YAVAPAI	A	PLACER	2018	03/27/2017	14 0120N 0010W 021	SW

**NO WARRANTY IS MADE BY BLM  
FOR USE OF THE DATA FOR  
PURPOSES NOT INTENDED BY BLM**

**Date and Time Run:**

9/25/2018 5:49:32 PM

Page 1 of @{numberOfPages}

**DEPARTMENT OF THE INTERIOR  
BUREAU OF LAND MANAGEMENT****Mining Claims****CUSTOMER INFORMATION****Admin State: AZ****Geo State: AZ****DICKINSON MALYNDA  
7815 W ROCK SPRINGS DR  
PEORIA AZ 85383-6208****Int Rel: CLAIMANT****Customer ID: 2414753**

Serial Number	Lead Serial Number	Claim Name	County	D	Case Type	Last A Yr	Location Date	Meridian Township Range Section	Subdiv
AMC444244	AMC444244	AZDG PARADISE	YAVAPAI	A	PLACER	2018	02/27/2017	14 0120N 0010W 021	SW
AMC444996	AMC444996	AZDG NORTH	YAVAPAI	A	PLACER	2018	04/27/2017	14 0120N 0010W 020	NE
AMC446086	AMC446086	LITTLE PICKER	YAVAPAI	A	PLACER	2019	09/01/2017	14 0090N 0050W 013	NE
AMC446087	AMC446086	LITTLE PICKER SOUTH	YAVAPAI	A	PLACER	2019	09/01/2017	14 0090N 0050W 013	NE

**NO WARRANTY IS MADE BY BLM  
FOR USE OF THE DATA FOR  
PURPOSES NOT INTENDED BY BLM**

UNITED STATES  
DEPARTMENT OF THE INTERIOR  
BUREAU OF LAND MANAGEMENT

MAINTENANCE FEE WAIVER CERTIFICATION

SEE INSTRUCTIONS ON PAGE 2

*233*

FORM APPROVED  
OMB NO. 1004-0114

Expires: October 31, 2016

*Current Form Rec'd 9/28/18 pb*

- This small miner waiver is filed for the assessment year beginning on September 1, 2018 and ending on September 1, 2019. *AC 247 removed.*
- The undersigned and all related parties owned ten or fewer mining claims, mill, or tunnel sites located and maintained on Federal lands in the United States of America on September 1, 2018.
- The undersigned have performed the assessment work required by law for each mining claim listed prior to filing this waiver and understand that by filing this form, the undersigned must file an affidavit of assessment work with the Bureau of Land Management (BLM) by the December 30th following the filing of this waiver.
- The undersigned understand that if the assessment work obligation has not yet come due under 30 U.S.C. 28 (for those claims in their first assessment year only), a notice of intent to hold reciting this condition must be recorded by the December 30th following the filing of this waiver.
- The undersigned understand that mill and tunnel sites may also be listed on this waiver and be waived from payment of the maintenance fee, and that a notice of intent to hold for these sites is required to be filed with the BLM by the December 30th following the filing of this waiver.
- The undersigned understand and acknowledge that pursuant to 43 U.S.C. 1212 and 18 U.S.C. 1001, the filing or recording of a false, fictitious, or fraudulent document with the BLM may result in a fine of up to \$250,000, a prison term not to exceed five years, or both.
- The mining claims, mill or tunnel sites for which this waiver from payment of the maintenance fees is requested are:

CLAIM OR SITE NAME	BLM RECORDATION SERIAL NUMBER
1. <u>AZDG Paradise</u>	<u>AMC 444244</u> (913)
2. <u>AZDG North</u> <i>→</i> <u>AMC 444996</u>	<u>AMC 444996</u> <del>X6</del> <i>pb</i>
3.	
4.	
5.	
6.	
7.	
8.	
9.	
10.	

The owner(s) (claimants) of the above mining claims and sites are:

40 Justin Allen Yeo  
(Owner's Name - Please Print)  
38024 N. 23rd Ave  
(Owner's Mailing Address)

*Jm*  
(Owner's Signature)  
Phoenix AZ 85086  
(City) (State) (Zip Code)

40 Malynnda Dickinson  
(Owner's Name - Please Print)  
7815 W. Rock Springs Dr.  
(Owner's Mailing Address)

*Mn*  
(Owner's Signature)  
Peoria AZ 85386  
(City) (State) (Zip Code)

(Owner's Name - Please Print)

(Owner's Signature)

(Owner's Mailing Address)

(City)

(State)

(Zip Code)

(Owner's Name - Please Print)

(Owner's Signature)

(Owner's Mailing Address)

(City)

(State)

(Zip Code)

(Continued on page 2)

PHOENIX, ARIZONA

2018 AUG 16 10:02

RECEIVED  
BLM AZ STATE OFFICE

ENTERED INTO COMPUTER

*AC 483 pb*  
*247 = Exp Form pb*  
*CURED on 8/28/18 pb*

*NW/pb*



\_\_\_\_\_  
(Owner's Name - Please Print)

\_\_\_\_\_  
(Owner's Signature)

\_\_\_\_\_  
(Owner's Mailing Address)

\_\_\_\_\_  
(City) (State) (Zip Code)

\_\_\_\_\_  
(Owner's Name - Please Print)

\_\_\_\_\_  
(Owner's Signature)

\_\_\_\_\_  
(Owner's Mailing Address)

\_\_\_\_\_  
(City) (State) (Zip Code)

\_\_\_\_\_  
(Owner's Name - Please Print)

\_\_\_\_\_  
(Owner's Signature)

\_\_\_\_\_  
(Owner's Mailing Address)

\_\_\_\_\_  
(City) (State) (Zip Code)

\_\_\_\_\_  
(Owner's Name - Please Print)

\_\_\_\_\_  
(Owner's Signature)

\_\_\_\_\_  
(Owner's Mailing Address)

\_\_\_\_\_  
(City) (State) (Zip Code)

18 U.S.C. 1001 and 43 U.S.C. 1212 make it a crime for any person knowingly and willfully to make to any department or agency of the United States any false, fictitious or fraudulent statements or representations as to any matter within its jurisdiction.

INSTRUCTIONS

1. This certification is made under the provisions of 43 U.S.C. § 1744 and 30 U.S.C. §28-28k and the regulations thereunder (43 CFR Part 3830).
2. The claimant(s) must fill in the dates in paragraph 1 for the beginning and ending of the assessment year for which this waiver is sought.
3. The claimant(s) must fill in the date in paragraph 2 for the beginning of the assessment year for which this waiver is sought.
4. All claim and site names and BLM serial numbers must be listed for the mining claims, mill sites, and tunnel sites for which the waiver is sought.
5. All owners of the mining claims, mill sites, and tunnel sites and their addresses must be given.
6. This waiver form must be signed by all the claimants or their designated agent, in original form. If an agent is designated, a notarized designation of agent, signed by all of the claimants with proper address given, must be submitted with this waiver.
7. This form must be filed no later than September 1st for the upcoming assessment year in the BLM State Office where the mining claims or sites are recorded, or the waiver cannot be granted by the BLM. (Example: To obtain a waiver for the assessment year 2012, which begins on September 1, 2011, you must qualify for and file for a waiver no later than September 1, 2011, in the proper BLM State Office.)
8. For all mining claims which require assessment work, you must record an affidavit of labor on or before the December 30th immediately following the filing of this waiver. For all other mining claims or sites waived, you must record a notice of intent to hold on or before the December 30th immediately following the filing of this waiver.
9. Mill and tunnel sites may also be listed on this waiver and be waived from payment of the maintenance fee. A notice of intent to hold for these sites is required to be filed by the December 30th following the filing of this waiver.

PHOENIX, ARIZONA  
 FOR OFFICIAL USE ONLY  
 2018 AUG 16 10 02  
 RECEIVED  
 BLM AZ STATE OFFICE

UNITED STATES  
DEPARTMENT OF THE INTERIOR  
BUREAU OF LAND MANAGEMENT

MAINTENANCE FEE WAIVER CERTIFICATION

FORM APPROVED  
OMB NO. 1004-0114  
Expires: January 31, 2020

SEE INSTRUCTIONS ON PAGE 2

- This small miner waiver is filed for the assessment year beginning on September 1, 2017 and ending on September 1, 2018.
- The undersigned and all related parties owned ten or fewer mining claims, mill, or tunnel sites located and maintained on Federal lands in the United States of America on September 1, 2017.
- The undersigned have performed the assessment work required by law for each mining claim listed prior to filing this waiver and understand that by filing this form, the undersigned must file an affidavit of assessment work with the Bureau of Land Management (BLM) by the December 30th following the filing of this waiver.
- The undersigned understand that if the assessment work obligation has not yet come due under 30 U.S.C. 28 (for those claims in their first assessment year only), a notice of intent to hold reciting this condition must be recorded by the December 30th following the filing of this waiver.
- The undersigned understand that mill and tunnel sites may also be listed on this waiver and be waived from payment of the maintenance fee, and that a notice of intent to hold for these sites is required to be filed with the BLM by the December 30th following the filing of this waiver.
- The undersigned understand and acknowledge that pursuant to 43 U.S.C. 1212 and 18 U.S.C. 1001, the filing or recording of a false, fictitious, or fraudulent document with the BLM may result in a fine of up to \$250,000, a prison term not to exceed five years, or both.
- The mining claims, mill or tunnel sites for which this waiver from payment of the maintenance fees is requested are:

CLAIM OR SITE NAME	BLM RECORDATION SERIAL NUMBER
1. AZDG PARADISE ✓	AMC444244
2. AZDG PARADISE #2	AMC444997
3. AZDG NORTH	AMC444996
4. AZ Gold Diggers 1	AMC443146
5.	
6.	
7.	
8.	
9.	
10.	

RECEIVED  
BLM STATE OFFICE  
2017 AUG 30 P 3:15  
PHOENIX, ARIZONA

The owner(s) (claimants) of the above mining claims and sites are:

Justin A. Yeo  
 (Owner's Name - Please Print)  
 38024 N. 23rd Ave  
 (Owner's Mailing Address)

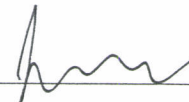
  
 (Owner's Signature)  
 Phoenix AZ 85086-9623  
 (City) (State) (Zip Code)

*Address updated*  
 Malynnda Dickinson  
 (Owner's Name - Please Print)  
 7815 W. Rock Springs Dr.  
 (Owner's Mailing Address)

  
 (Owner's Signature)  
 Peoria AZ 85383  
 (City) (State) (Zip Code)

*Address updated*  
 Kevin Garrigus  
 (Owner's Name - Please Print)  
 1628 E Circle Mountain Rd  
 (Owner's Mailing Address)

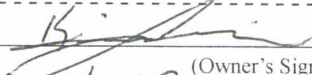
  
 (Owner's Signature)  
 New River AZ 85087  
 (City) (State) (Zip Code)

(Owner's Name - Please Print) 483  
 (Owner's Mailing Address)

(Owner's Signature)  
 (City) (State) (Zip Code)

(Continued on page 2)

SEP 13 2017  
 BLM

*nwv*

AMC 443146  
444244

491 JK

Amc 444244  
 Amc 444996  
 Amc 443146

**NOTICE OF INTENTION TO HOLD MINING CLAIMS/SITES**

When Recorded Return Document to:

Justin A. Yeo  
38024 N. 23rd Ave  
Phoenix, AZ 85086-9623

RECEIVED  
 STATE OFFICE  
 2017 AUG 30 P 3:15  
 PHOENIX, ARIZONA  
 BLM  
 Date  
 Stamp

Check here if this is a change of address.

Telephone: 602-502-9109

E-mail Address: \_\_\_\_\_

I (We) intend to hold the claims(s) and/or site(s) listed below for the calendar year 20\_\_\_\_, and I (We) have filed or will file a Notice of Intent to Hold in the county where the claim (s) is located.

Reason for filing a Notice of Intent to Hold instead of an assessment work filing (check one):

- Maintenance fee was paid to maintain claim(s) during this assessment year.
- Mill or tunnel sites.
- Claim(s) was located during the current assessment year.
- BLM has deferred assessment work (attach copy of decision granting deferment, or pending petition for deferment including date petition was filed.)

Line No.	AMC NUMBER	CLAIM/SITE NAME	COUNTY RECORDER DATA (If available)	TWP	RNG	SEC
1	444244	AZOG Paradise	2017-0028094	12N	1W	21
2	444997	AZOG Paradise #2	2017-0031721	12N	1W	21
3	444996	AZOG North	2017-0031722	12N	1W	20
4	443146	AZ Gold Diggers 1	2017-0018025	8N	4W	7
5						
6						
7						
8						
9						
10						

AT 9/7/17

NOTICE OF INTENTION TO HOLD MINING CLAIMS/SITES  
page 2

RECEIVED  
STATE OFFICE  
2017 AUG 30 P 3:15  
PHOENIX, ARIZONA  
BLM  
Date  
Stamp

1. State of Arizona, County of Yavapai

2. I (Name) Justin Allen Yeo

3. Reside at (Address) 38024 N. 23rd Ave

City Phoenix County \_\_\_\_\_ State AZ Zip 85086 being duly sworn, depose and say that I am a citizen of the United States, more than eighteen years of age, that all of the facts set forth in this notice, subject to the provisions and penalties of 18 U.S.C. 1001 pertaining to the filing of false, fictitious, or fraudulent statements with the United States, are true and correct according to the best of my knowledge, information and belief.

4. Owner's name and address (If not shown in Items 1-3 above). \_\_\_\_\_

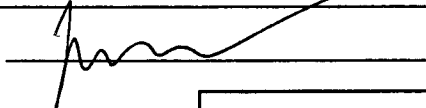
5. Dated: 8/28/17 Signature: 

Bureau of Land Management  
Arizona State Office  
[www.blm.gov/az](http://www.blm.gov/az)

No. of Claims: 4 x \$10 = 40<sup>00</sup>  
Check No: CASH Init. PER  
Receipt No.: 3966350  
For BLM Use Only

Form: MCF110  
Revised July 2014  
Page 2 of 2

**United States Department of the Interior**  
**Bureau of Land Management**  
 DIV OF LANDS, MINRLS & ENERGY  
 ONE N CENTRAL AVE  
 PHOENIX, AZ 85004 -4427  
 Phone: 602-417-9200

Receipt

No: 3966350

<b>Transaction #:</b> 4076234	
<b>Date of Transaction:</b> 08/30/2017	
CUSTOMER:	
JUSTIN A YEO 38024 N 23RD AVE PHOENIX, AZ 85086-9623 US	

LINE #	QTY	DESCRIPTION	REMARKS	UNIT PRICE	TOTAL
1	1.00	LOCATABLE MINERALS / MINING CLAIMS- NOT NEW-UNADJUD, ONE AUTH NO. ONLY / MINING CLAIM MONEY RECEIVED CASES: AMC444244/\$40.00	2017 NOI/4 AND WAIVER	- n/a -	40.00
<b>TOTAL:</b>					<b>\$40.00</b>

PAYMENT INFORMATION			
1	AMOUNT:	40.00	POSTMARKED: N/A
	TYPE:	CASH	RECEIVED: 08/30/2017
	NAME:	YEO, JUSTIN A 38024 N 23RD AVE PHOENIX AZ 85086-9623 US	

REMARKS

This receipt was generated by the automated BLM Collections and Billing System and is a paper representation of a portion of the official electronic record contained therein.

UNITED STATES  
DEPARTMENT OF THE INTERIOR  
BUREAU OF LAND MANAGEMENT

4930

Amc 443770  
444244

MAINTENANCE FEE WAIVER CERTIFICATION

FORM APPROVED  
OMB NO. 1004-0114  
Expires: January 31, 2020

SEE INSTRUCTIONS ON PAGE 2

1. This small miner waiver is filed for the assessment year beginning on September 1, 2017 and ending on September 1, 2018.
2. The undersigned and all related parties owned ten or fewer mining claims, mill, or tunnel sites located and maintained on Federal lands in the United States of America on September 1, 2017.
3. The undersigned have performed the assessment work required by law for each mining claim listed prior to filing this waiver and understand that by filing this form the undersigned must file an affidavit of assessment work with the Bureau of Land Management (BLM) by the December 30th following the filing of this waiver.
4. The undersigned understand that if the assessment work obligation has not yet come due under 30 U.S.C. 28 (for those claims in their first assessment year only), a notice of intent to hold reciting this condition must be recorded by the December 30th following the filing of this waiver.
5. The undersigned understand that mill and tunnel sites may also be listed on this waiver and be waived from payment of the maintenance fee, and that a notice of intent to hold for these sites is required to be filed with the BLM by the December 30th following the filing of this waiver.
6. The undersigned understand and acknowledge that pursuant to 43 U.S.C. 1212 and 18 U.S.C. 1001, the filing or recording of a false, fictitious, or fraudulent document with the BLM may result in a fine of up to \$250,000, a prison term not to exceed five years, or both.
7. The mining claims, mill or tunnel sites for which this waiver from payment of the maintenance fees is requested are:

CLAIM OR SITE NAME	BLM RECORDATION SERIAL NUMBER
1. Legacy I ✓	AMC 443770
2. Legacy II	AMC 444245
3.	
4.	
5.	
6.	
7.	
8.	
9.	
10.	

The owner(s) (claimants) of the above mining claims and sites are:

David D. Warner  
(Owner's Name - Please Print)  
3810 E. Glenrosa Ave.  
(Owner's Mailing Address)

[Signature]  
(Owner's Signature)  
Phoenix AZ 85018  
(City) (State) (Zip Code)

\_\_\_\_\_  
(Owner's Name - Please Print)  
\_\_\_\_\_  
(Owner's Mailing Address)

\_\_\_\_\_  
(Owner's Signature)  
\_\_\_\_\_  
(City) (State) (Zip Code)

\_\_\_\_\_  
(Owner's Name - Please Print)  
\_\_\_\_\_  
(Owner's Mailing Address)

\_\_\_\_\_  
(Owner's Signature)  
\_\_\_\_\_  
(City) (State) (Zip Code)

[Signature]  
(Owner's Name - Please Print)  
\_\_\_\_\_  
(Owner's Mailing Address)

[Signature]  
(Owner's Signature)  
\_\_\_\_\_  
(City) (State) (Zip Code)

(Continued on page 2)

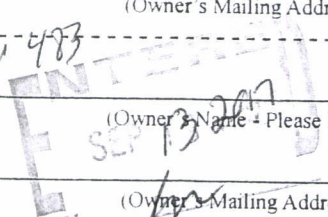

nwd

(Owner's Name - Please Print)	(Owner's Signature)		
(Owner's Mailing Address)	(City)	(State)	(Zip Code)
(Owner's Name - Please Print)	(Owner's Signature)		
(Owner's Mailing Address)	(City)	(State)	(Zip Code)
(Owner's Name - Please Print)	(Owner's Signature)		
(Owner's Mailing Address)	(City)	(State)	(Zip Code)
(Owner's Name - Please Print)	(Owner's Signature)		
(Owner's Mailing Address)	(City)	(State)	(Zip Code)

18 U.S.C. 1001 and 43 U.S.C. 1212 make it a crime for any person knowingly and willfully to make to any department or agency of the United States any false, fictitious or fraudulent statements or representations as to any matter within its jurisdiction.

**INSTRUCTIONS**

1. This certification is made under the provisions of 43 U.S.C. § 1744 and 30 U.S.C. §28-28k and the regulations thereunder (43 CFR Part 3830).
2. The claimant(s) must fill in the dates in paragraph 1 for the beginning and ending of the assessment year for which this waiver is sought.
3. The claimant(s) must fill in the date in paragraph 2 for the beginning of the assessment year for which this waiver is sought.
4. All claim and site names and BLM serial numbers must be listed for the mining claims, mill sites, and tunnel sites for which the waiver is sought.
5. All owners of the mining claims, mill sites, and tunnel sites and their addresses must be given.
6. This waiver form must be signed by all the claimants or their designated agent, in original form. If an agent is designated, a notarized designation of agent, signed by all of the claimants with proper address given, must be submitted with this waiver.
7. This form must be filed no later than September 1st for the upcoming assessment year in the BLM State Office where the mining claims or sites are recorded, or the waiver cannot be granted by the BLM. (Example: To obtain a waiver for the assessment year 2012, which begins on September 1, 2011, you must qualify for and file for a waiver no later than September 1, 2011, in the proper BLM State Office.)
8. For all mining claims which require assessment work, you must record an affidavit of labor on or before the December 30th immediately following the filing of this waiver. For all other mining claims or sites waived, you must record a notice of intent to hold on or before the December 30th immediately following the filing of this waiver.
9. Mill and tunnel sites may also be listed on this waiver and be waived from payment of the maintenance fee. A notice of intent to hold for these sites is required to be filed by the December 30th following the filing of this waiver.

FOR OFFICIAL USE ONLY

PHOENIX, ARIZONA

2011 AUG 30 P 1:57

RECEIVED

BLM STATE OFFICE

**NOTICE!!**

**These documents have been scanned!**

**Do not place un-scanned documents beneath this notice!**

**Do not remove this notice from this file!**

GPO Jacket No. 560-102  
Print Order 61540  
Rise Business Services, LLC  
Job=AZ15 4/29/2019



Box Number= AZ15007



Claim Begin-End: AMC444244-AMC444245

5 Miscellaneous



AZ15007-4 AMC450400-AMC453366



**NO  
DOCUMENTS  
FOUND**

NO DOCUMENTS FOUND  
NO DOCUMENTS FOUND

**NOTICE!!**

**These documents have been scanned!**

**Do not place un-scanned documents beneath this notice!**

**Do not remove this notice from this file!**

GPO Jacket No. 560-102  
Print Order 61540  
Rise Business Services, LLC  
Job=AZ15 4/29/2019



Box Number= AZ15007



Claim Begin-End: AMC444244-AMC444245

6 Location Notices-Amendments and Supporting Documents



AZ15007-4 AMC450400-AMC453366

**MINING CLAIM STATUS REPORT**

Data Entered: 05/30/17 RAM

MTP Checked By: YMC  
GEO Checked By: YMC

LEAD SERIAL NUMBER: AMC 444244 thru AMC 444245

**NUMBER OF CLAIMS & TYPE:**

2 LODE  
2 PLACER  
ASSOCIATION PLACER  
MILL SITE  
TUNNEL SITE

**CHARGES:**

Processing Fee @ \$20 = \$ 40  
Location Fee @ \$37 = \$ 74  
Maintenance Fee @ \$155 = \$ 310  
Add'l Maint Fee for Assoc Placer = \$  
**SUBTOTAL** \$  
Other Fees \$  
Other Fees \$  
**TOTAL** \$ 424

TOTAL ACREAGE: 20 Per Claim  
(Placer Only)

NUMBER OF LOCATORS: 2

DOCUMENTS RECEIVED VIA: Over-the-Counter [ ] Mail  **TIMELY FILED:** Yes  No [ ]

LEGAL DESCRIPTION: T 12N R 1W SEC 21  
T 8N R 5W SEC  
T R SEC  
T R SEC  
T R SEC

BLM [ ] FOREST SERVICE [ ] SUBJ TO PL 359: Yes [ ] No [ ]  
WILDERNESS AREA [ ]

SPLIT ESTATE: N/A [ ] SX [ ] PX [ ] OTHER [ ]  
SRHA [ ] Was proper Notice filed if located on SHRA Land? Yes [ ] No [ ]

RECONVEYED MINERALS ON BLM LAND REQUIRE OPENING ORDER FROM 1944 TO 1993:  
Open to Entry On \_\_\_\_\_ N/A [ ]

COMMENTS/STATUS: VOID [ ] PARTIALLY VOID [ ] PVT MINERALS [ ] WITHDRAWN LANDS [ ]  
OTHER [ ]

[ ] Claimant acknowledges that portions of the following claim(s) site(s) may be void or voidable.

Printed Name of Claimant \_\_\_\_\_ Signature of Claimant \_\_\_\_\_

\*\*\*\*\*FINAL ADJUDICATION\*\*\*\*\*

DATE 1/24/2018 INITIALS for 444244 only

AMC444244

LOCATION NOTICE FOR PLACER MINING CLAIM

Amendment BLM Serial # \_\_\_\_\_

NOTICE IS HEREBY GIVEN that the **AZDG Paradise** mining claim has been located by **Justin Allen Yeo** whose current mailing address is:

**38024 N. 23<sup>rd</sup> Ave, Phoenix, AZ 85086**

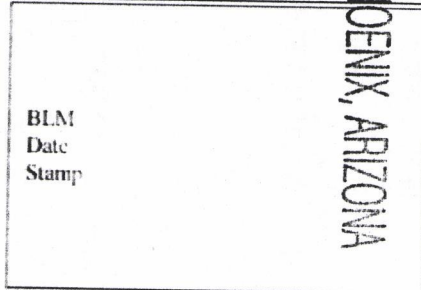

2017 MAY 23 P 12:00

RECEIVED  
BLM AZ STATE OFFICE

The general course of this claim is **North to South** and it is situated in **Yavapai** County, Arizona. This claim is approximately **660** feet in length and **1320** feet in width. **20 Acres** Total Claim Acreage. This claim runs from the location monument on which this location notice is posted at the **SE** corner of the claim and runs approximately **1320** feet in a **North** direction to the **North** end line and **660** feet in a **West** direction to the **West** end line. This claim is marked by four monuments, one at each corner of the claim. The location monument on which this notice is posted is situated within Section 21, Township **12N**, Range **1W**, Gila Salt River Base and Meridian, Arizona. This claim encompasses portions of the following legal subdivision(s) if located by legal subdivision or the following quarter section(s), section(s), Township(s) and Range(s) **This claim is the 20 acre parcel that is the W 1/2 of the SW 1/4 of the SW 1/4 of Section 21, Township 12N, Range 1W, Gila Salt River Base and Meridian, Arizona.** The locality of this claim with reference to some natural object or permanent monument and additional information (if any) concerning its locality are as follows: **The SW Corner of this claim is located at the SW corner of Section 21.**

The above information is shown on the attached map. DATED AND POSTED on the ground this **27<sup>th</sup>** day of **February**, 2017.

Locators:

Printed Name Justin Allen Yeo Signature(s) \_\_\_\_\_

Printed Name Malynda Dickinson Signature(s) \_\_\_\_\_

Printed Name \_\_\_\_\_ Signature(s) \_\_\_\_\_

Printed Name \_\_\_\_\_ Signature(s) \_\_\_\_\_

Printed Name \_\_\_\_\_ Signature(s) \_\_\_\_\_

AH C 4 4 4 2 4 4

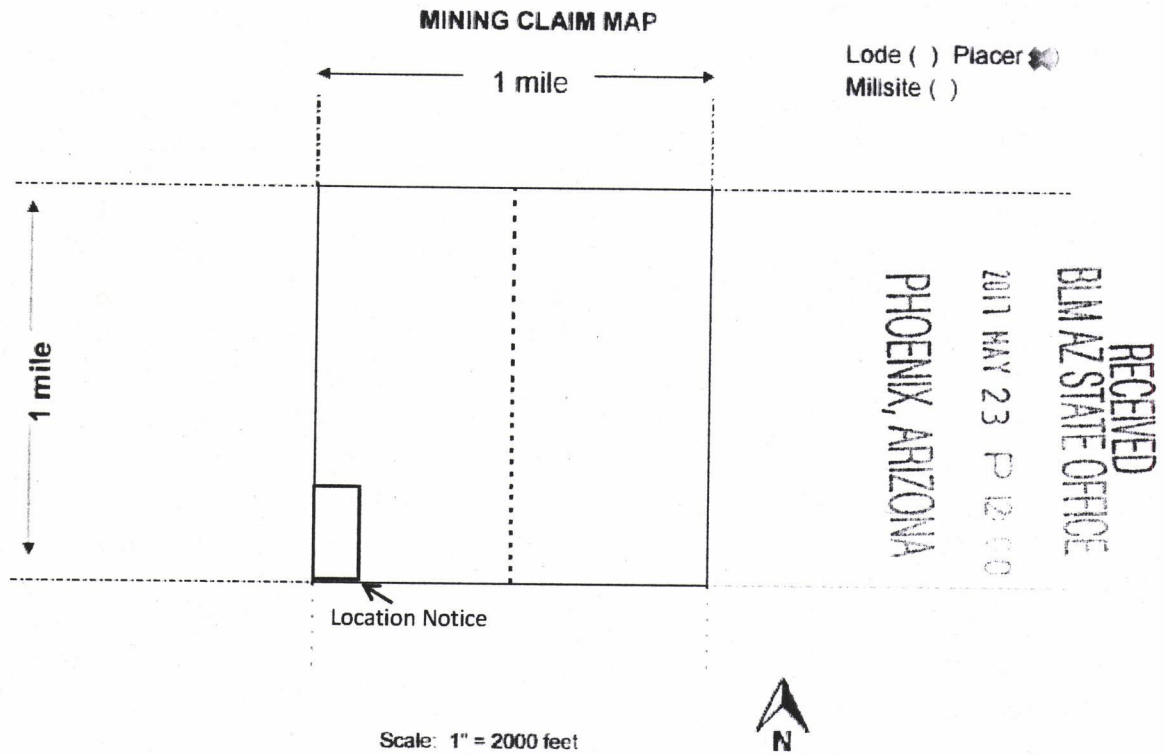

1. The above map depicts the **AZDG Paradise** mining claim, which is located in Section(s) **6**, Township **8N**, Range **4W** Gila and Salt River Base and Meridian, **Yavapai** County, Arizona.

Total claim acreage is **20 Acres**.

2. The type of corner and location monuments used are as follows: **2" PVC Capped**

3. The bearings and distances in degrees and feet between claim corners and to a public land survey monument are as depicted on the map. **The SW Corner of this claim is located at the SW corner of Section 21.**

4. If the claim is a placer or millsite claim with exterior limits conforming to legal subdivisions of the public survey, provide a legal description of the claim: **This claim is the 20 acre parcel that is the W 1/2 of the SW 1/4 of the SW 1/4 of Section 21, Township 12N, Range 1W, Gila Salt River Base and Meridian, Arizona**

This form is available from the Arizona Geology Survey and may be reproduced.

AR 0444244

LOCATION NOTICE FOR PLACER MINING CLAIM

Amendment BLM Serial # \_\_\_\_\_

NOTICE IS HEREBY GIVEN that the **Legacy #2** mining claim has been located by **David D. Warner** whose current mailing address is:

**3810 E. Glenrosa Ave. Phoenix, AZ 85018**

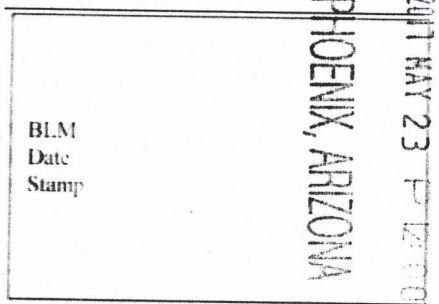

RECEIVED  
BLM AZ STATE OFFICE

The general course of this claim is **East to West** and it is situated in **Yavapai** County, Arizona. This claim is approximately **640** feet in length and **1320** feet in width. **20 Acres** Total Claim Acreage. This claim runs from the location monument on which this location notice is posted at the **SW** corner of the claim and runs approximately **640** feet in a **North** direction to the **North** end line and **1320** feet in a **East** direction to the **East** end line. This claim is marked by four monuments, one at each corner of the claim. The location monument on which this notice is posted is situated within Section **1**, Township **8N**, Range **5W**, Gila Salt River Base and Meridian, Arizona. This claim encompasses portions of the following legal subdivision(s) if located by legal subdivision or the following quarter section(s), section(s), Township(s) and Range(s) **This claim is the 20 acre parcel that is the S 1/2 of the SE 1/4 of the SE 1/4 of Section 1, Township 8N, Range 5W, Gila Salt River Base and Meridian, Arizona.** The locality of this claim with reference to some natural object or permanent monument and additional information (if any) concerning its locality are as follows: **The SE Corner of this claim is located at the SE corner of Section 1.**

The above information is shown on the attached map. DATED AND POSTED on the ground this **6<sup>th</sup>** day of **April**, 2017.

Locators:

Printed Name David D. Warner Signature(s) 

Printed Name \_\_\_\_\_ Signature(s) \_\_\_\_\_

Printed Name \_\_\_\_\_ Signature(s) \_\_\_\_\_

Printed Name \_\_\_\_\_ Signature(s) \_\_\_\_\_

Printed Name \_\_\_\_\_ Signature(s) \_\_\_\_\_

Printed Name \_\_\_\_\_ Signature(s) \_\_\_\_\_

AMC444245

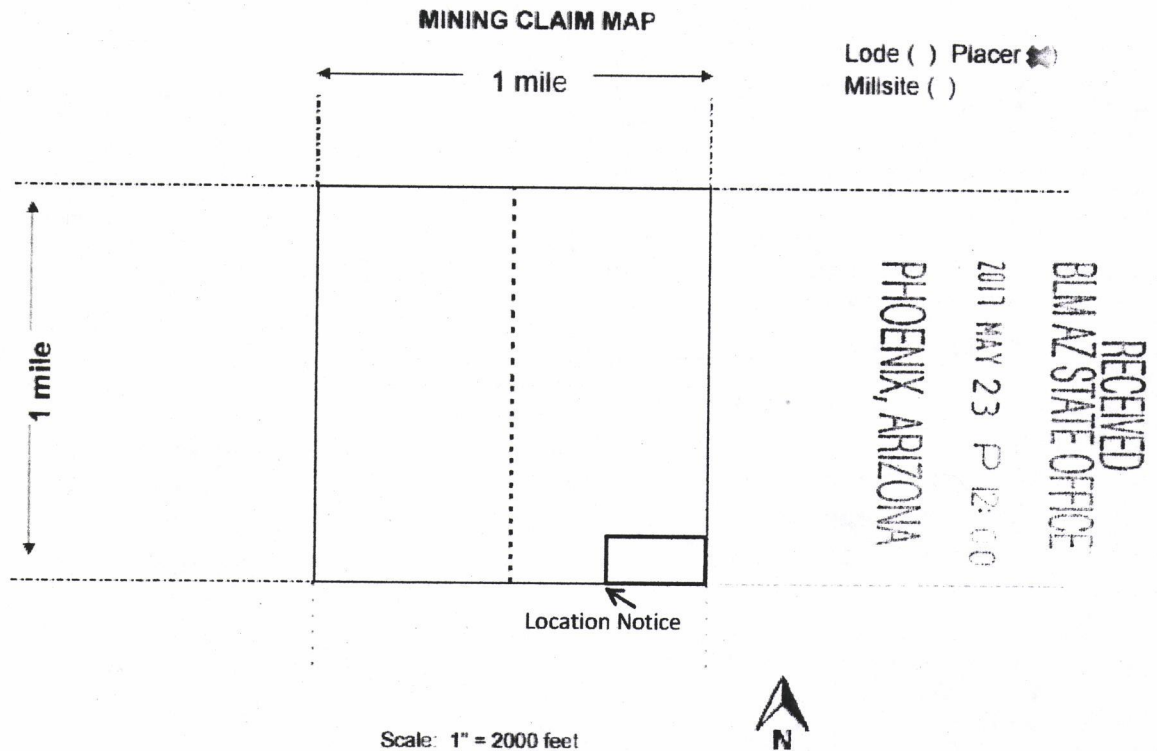

1. The above map depicts the **Legacy #2** mining claim, which is located in Section(s) **1**, Township **8N**, Range **5W** Gila and Salt River Base and Meridian, **Yavapai** County, Arizona.

Total claim acreage is **20 Acres**.

2. The type of corner and location monuments used are as follows: **2" PVC Capped**

3. The bearings and distances in degrees and feet between claim corners and to a public land survey monument are as depicted on the map. **The SE Corner of this claim is located at the SE corner of Section 1.**

4. If the claim is a placer claim with exterior limits conforming to legal subdivisions of the public survey, provide a legal description of the claim: **This claim is the 20 acre parcel that is the S 1/2 of the SE 1/4 of the SE 1/4 of Section 1, Township 8N, Range 5W, Gila Salt River Base and Meridian, Arizona**

This form is available from the Arizona Geology Survey and may be reproduced.

AMC444245

When Recorded Return Document to:

\_\_\_\_\_  
\_\_\_\_\_  
\_\_\_\_\_

### STATEMENT OF AGREEMENT

I \_\_\_\_\_ of \_\_\_\_\_ as  
PRINT FIRST and LAST NAME PRINT CURRENT ADDRESS

Owner of AMC444245, LEGACY #2, do hereby agree to follow and comply with the stipulations set forth by the DEPARTMENT OF THE INTERIOR, Bureau of Land Management, Arizona and described within:

**Gila and Salt River Meridian, Yavapai County, Arizona**

T. 8 N., R. 5 W.,

sec. 1.

Order Providing for the Opening of Public Lands to Mineral Location, Entry, and Patent – dated November 21, 1958.

The Order is attached and made part of this agreement.

Dated this \_\_\_\_\_ day of \_\_\_\_\_, 20\_\_.

By \_\_\_\_\_

STATE OF \_\_\_\_\_ )  
County of \_\_\_\_\_ )

This instrument was acknowledged and executed before me, this \_\_\_\_\_ day of \_\_\_\_\_, 20\_\_ by \_\_\_\_\_, he/she acknowledged that he/she executed the same for the purpose set forth herein.

My commission expires: \_\_\_\_\_

\_\_\_\_\_  
Notary Public

(SEAL)



58 9964

UNITED STATES

DEPARTMENT OF THE INTERIOR  
Bureau of Land Management

Document No. 195

11-21-58

# 48707

ARIZONA

ORDER PROVIDING FOR THE OPENING OF PUBLIC LANDS  
TO MINERAL LOCATION, ENTRY, AND PATENT

Under the authority of the Act of April 25, 1932 (47 Stat. 136; 43 U.S.C. 154) and the regulations thereunder contained in 43 C.F.R. 185.36, and pursuant to section 2.22 (a) of Departmental Order No. 2583 of August 16, 1950, of the Secretary of the Interior, it is ordered as follows:

Subject to valid existing rights and the provisions of existing withdrawals, the following described lands shall, commencing at 10:00 a.m., on the thirty-fifth day after the date of this Order, be open to location, entry, and patenting under the United States Mining Laws, subject to the stipulations quoted below, to be executed and acknowledged in favor of the United States by the locators, for themselves, their heirs, successors, and assigns, and recorded in the county records and in the United States Land & Survey Office at Phoenix, Arizona, before any rights attach thereto:

GILA AND SALT RIVER MERIDIAN

T. 7 N., R. 4 W.,  
Sec. 20: W/4SW/4SW

T. 8 N., R. 4 W.,  
Sec. 7: Lots 5, 6, 7, 8, 9, 10, 11,  
12, 13, 14, 15 and 16

*Parted 12/12/58 J. G. S. L. R. Doc. 195*

T. 8 N., R. 5 W.,  
Sec. 1: Lots 1, 2, 3, 4, 5, 6, 7  
SW<sup>1</sup>/<sub>4</sub>, S<sup>2</sup>/<sub>4</sub>SW<sup>1</sup>/<sub>4</sub>, SW<sup>3</sup>/<sub>4</sub>, W<sup>2</sup>/<sub>4</sub>SE<sup>1</sup>/<sub>4</sub>

The area described totals 1,064.87 acres.

Disposition of the lands described herein shall be subject to the following stipulations:

In carrying out the mining and milling operations contemplated hereunder, locator will, by means of substantial dikes or other adequate structures, confine all tailings, debris, and harmful chemicals in such a manner that the same shall not be carried into the Hassayampa River by storm waters or otherwise.

There is reserved to the United States, its agents and employees, at all times, free ingress to, passage over, and egress from all of the above described lands for the purpose of inspection; there is further reserved to the United States, its successors and assigns the prior right to use any of the lands hereinabove described, to construct, operate, and maintain canals, dikes, wasteways, ditches, dams, reservoirs, telephone and telegraph lines, electric transmission lines, roadways and appurtenant works, including the right to take and remove from the lands hereinabove described such construction materials as may be required in the construction of irrigation works, without any payment made by the United States, or its successor for such rights.

The locator further agrees that the United States, its officers, agents, and employees and its successors or assigns, shall

not be held liable for any damage to the improvements or workings of the locator resulting from the construction, operation and maintenance of any works of the United States and/or the removal of construction materials from the lands hereinabove described.

Inquiries concerning these lands shall be addressed to the Manager, Land Office, Bureau of Land Management, P.O. Box 148, Phoenix, Arizona.



E. I. Rowland  
State Supervisor

NOV 21 1958

I certify this to be a true copy of the original.



E. I. Rowland  
State Supervisor

THE NATIONAL ARCHIVES  
AND RECORDS SERVICE  
FILED AND MADE AVAILABLE  
FOR PUBLIC INSPECTION

Dec 2 8 45 AM '58  
IN THE FEDERAL REGISTER  
DIVISION 73

Document 195

Input Parameters for Geographic Report with Land

System Id = CR

Admin State = AZ

Geo State =

Casetype Begins With

Case Disp Txt = AUTHORIZED, CANCELLED, EXPIRED, PENDING, REJECTED, RELINQUISHED, VOID, WITHDRAWN

Mer Twp Rng =

Section =

Mtrs = 14 0080N 0050W 001, 14 0080N 0050W 999, 14 0120N 0010W 021, 14 0120N 0010W 999

Commodity =

Commodity Txt =

Pending Org =

Pend Org Decode =

Total Rows Returned: 3

RUN TIME: 11:57 AM

Adm State: AZ

UNITED STATES DEPARTMENT OF INTERIOR  
BUREAU OF LAND MANAGEMENT  
GEOGRAPHIC REPORT WITH LAND  
Sorted by Meridian Township Range

RUN DATE: 05/23/2017  
Page 1 of 1

Serial Number: AZA 031568

Total Case Acres: 1.000

<u>Casetype</u>	<u>Case Disp</u>				<u>Sect</u>	<u>Sur Typ</u>	<u>Sur Num</u>	<u>Suff</u>	<u>Subdivision</u>	<u>Act Pend</u>
293200	EXPIRED	14	0080N	0050W	001	FF			PORTION OF;	

Serial Number: AZAR 0034626

Total Case Acres: 26.550

<u>Casetype</u>	<u>Case Disp</u>				<u>Sect</u>	<u>Sur Typ</u>	<u>Sur Num</u>	<u>Suff</u>	<u>Subdivision</u>	<u>Act Pend</u>
286202	AUTHORIZED	14	0080N	0050W	001	ALIQ LOTS			SENW,E2SW; 3;	

TOWNSHIP 08 NORTH RANGE 05 WEST OF THE GILA & SALT RIVER MERIDIAN, ARIZONA

SECS	SUBDIVISION																Acres	Kind of Entry or Purpose	Serial Number or Order Number	Action Date	Remarks			
	NE 1/4				NW 1/4				SW 1/4				SE 1/4									Lots	Other Description	
	NE	NW	SW	SE	NE	NW	SW	SE	NE	NW	SW	SE	NE	NW	SW	SE								
For orders affecting disposal or use of unidentified lands withdrawn for classification, minerals, water, and/or other public purposes, and Indian treaties, refer to Index to Miscellaneous Documents																								
13							X	X	X	X	X	X					3	8N 4W;	279.51	O REST PWR SITE RESERVE 188, SO 6/16/1911	AR-13	11/12/1954	OPEN TO ENTRY;	
11	X	X	X	X	X	X	X	X	X	X	X	X				X								
12																		ALL;						
13																		ALL;						
14	X		X	X			X									X	X	2007.34	O OPENING TO ME	AR-14	11/12/1954	SUBJ TO STIPULATIONS;		
1			X				X	X	X	X	X	X				X	X	1-7	7N 4W;		AR-195	11/21/1958	SUBJ TO STIPULATIONS;	
25											X							R/W TRANSMISSION LINE	AR-030524	8/22/1961	PREPERMIT; APPVD 9/14/1961; TO TERM 9/13/2011;			
9																		NWSENE;	10.00	SLUP ELECTRONIC TESTING AREA	AR-031175	2/9/1962	EXPIRED 2/8/1964;	
22	X	X	X		X	X	X	X	X	X	X	X												
27		X	X	X	X	X	X												680.00	O CL / PS BLM MOTION	AR-021633	12/27/1962	CANC;	
23																		W2SENE, E2SENE, E2NENE, W2NENE, E2NENE, W2NENE, E2NENE, W2NENE, W2SWNE, E2SWNE;		MINING CLAIM LOCATION - PL 359	AR-034576	1/21/1965	MILLSITES; CLOSED 9/28/1973;	
1								X	X			X					3							
12						X			X	X		X				X								
13		X	X		X												3, 4							
24			X													X	X	2						
25		X	X													X	X				R/W TELEPHONE AND TELEGRAPH LINE	AR-034626	11/10/1965	TO TERM 10/28/2015; OTHER TPS: 9N 5W, 10N 5W, 12 1/2N 3W;
9																		A STRIP OF LAND 50 FT WIDE;	6.555	SLUP	A-43	8/17/1966	TO EXPIRE 8/16/1971; EXT; EXPIRED 6/16/1976;	
3																		ALL;						
10																		ALL;						
11																		ALL;						
15																		ALL;						
22																		ALL;		O CANC WDL PWR PROJECT AR-774, O 12/31/1935	A-795	3/17/1967	FPC; 13N 2W;	
24	X	X	X	X	X			X	X			X	X	X	X	X	X	1N 4W;		O PROPOSED CL FOR MULTIPLE USE MANAGEMENT	A-1100	7/21/1967	SEGREGATES THE PUBLIC LANDS FROM APPROPRIATION UNDER AGRICULTURAL LAND LAWS, PS, SX; PUB IN FR 7/27/1967; O CL 10/17/1967; PUB IN FR 10/23/1967; CL TERM 10/7/1981;	
22	X	X	X		X	X	X	X	X	X	X	X					6N 4W;	440.00	IL		399	10/2/1967		
27		X	X	X	X	X	X										13N 27E;	240.00	IL		421	3/12/1968		
12																	M&B;		MINING CLAIM LOCATION - PL 359	AR-036159	10/8/1968	FILED 12/10/1956;		
12																	M&B;		MINING CLAIM LOCATION - PL 359	AR-036160	10/8/1968	FILED 12/10/1956;		



# TOWNSHIP 12 NORTH RANGE 1 WEST OF THE GILA AND SALT RIVER MERIDIAN, ARIZONA

YAVAPAI COUNTY  
HASSAYAMPA FIELD OFFICE

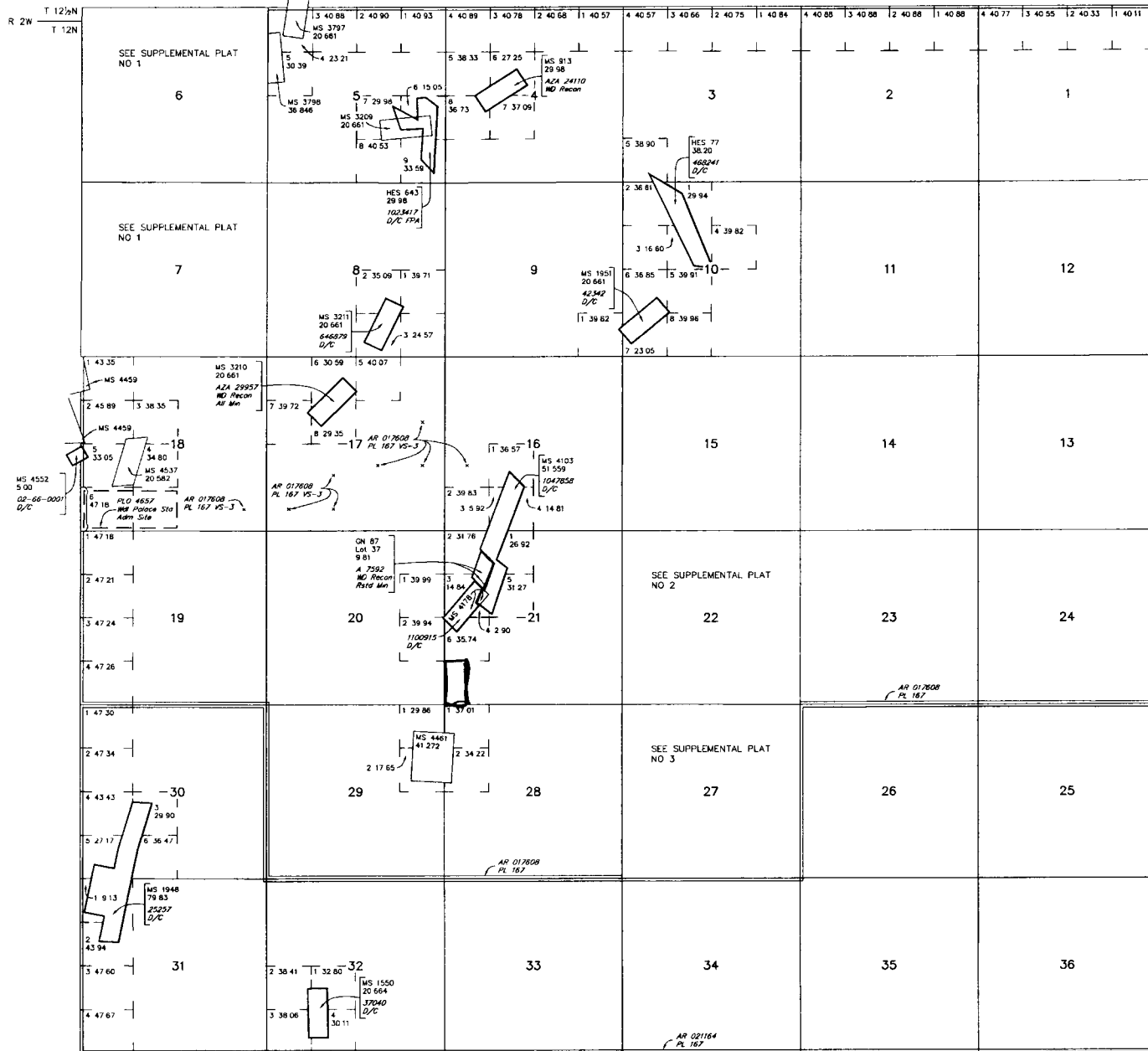

STATUS OF PUBLIC DOMAIN  
LAND AND MINERAL TITLES  
AND ACQUIRED LANDS

INDEX TO SEGREGATED TRACTS				
RESURVEY TRACT NO	ORIGINAL SURVEY			
	T	R	SEC	SUBDIVISION

FOR ORDERS AFFECTING DISPOSAL OR USE OF UNIDENTIFIED LANDS WITHDRAWN FOR CLASSIFICATION, MINERALS, WATER AND/OR OTHER PUBLIC PURPOSES, REFER TO INDEX OF MISCELLANEOUS DOCUMENTS.

- MDS 218 NE
- 219 NW
- 220 SW
- 221 SE

All Tracts Included in WPA Prescott NF EO 90A 7/21/1908

T 12 N  
T 11 1/2 N R 1 E

Lat 34 19'53.4"N  
Long 112°18'15.2"W

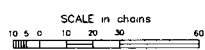

**WARNING STATEMENT**  
This plot is the Bureau's Record of Title, and should be used only as a graphic display of the township survey data. Records herein do not reflect title changes which may have been affected by lateral movements of rivers or other bodies of water. Refer to the cadastral surveys for official survey information.

CURRENT TO	LT	GSR Mer
3-15-2016	ACAD	T 12 N
		R 1 W